



Solenoid valve 3/2 way N.C. Direct acting

31A1AR10
÷
31A1AR25

PRESENTATION:

Direct acting S.V. for interception of fluids compatible with the construction materials.

Minimum operational pressure is not required.

The materials used and the tests carried out ensure maximum reliability and duration.

USE: Hot water
Steam (180°C)

PIPES: subplate mounting

COILS: 8W - Ø 13
BDA - BDS - BSA 155°C (class F)
BDP 160°C (high temperature)
BDF 180°C (class H)
SDH 180°C (class H)

Max. allowable pressure (PS) 40 bar
Environment temperature:
with class **F** or high temperature coils - 40°C + 60°C
with class **H** coil - 40°C + 80°C



Gaskets	Temperature		Medium
R=RUBY	- 40°C	+ 180°C	Hot water, Steam

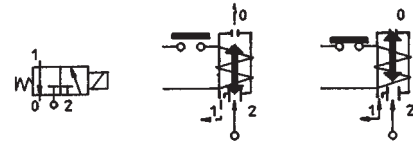

Pipe	Code	Max viscosity		Ø mm	Kv l/mn	Power (watt)	Pressure		
		cSt	°E				min	M.O.P.D.	
							bar	AC bar	DC bar
SUBPLATE MOUNTING	31A1AR10	-	-	1*	0,45	8	0	20	20
	31A1AR15			15	15				
	31A1AR20			10	10				
	31A1AR25			6	6				

Note

* 3rd way exhaust= Ø 2,5 mm

Also available with brass body without lead.

The use of rigid sealings usually implies a slight leakage, limited within 2scc/min at the pressure of 1 bar.

The "ODE" reserves the right to carry out technical and aesthetic modifications without prior notification.

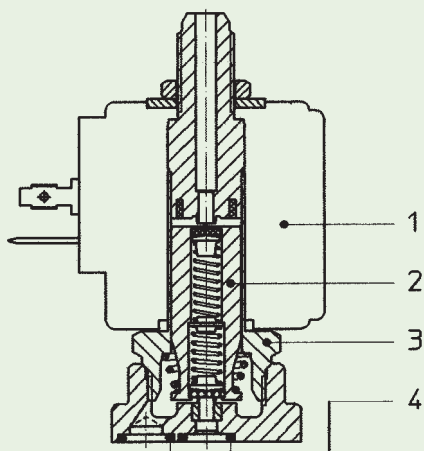

MATERIALS:

- Body** Brass - UNI EN 12165 CW617N
- Armature tube** Stainless steel AISI series 300
- Fixed core** Stainless steel AISI series 400
- Plunger** Stainless steel AISI series 400
- Phase displacement ring** Copper - Cu 99,9%
- Spring** Stainless steel AISI series 300
- Seal** R=RUBY
- Orifice: Insert slot** Stainless steel AISI series 300

On request:

- Connector** Pg 9 or Pg 11
- Connector conformity** ISO 4400

FEATURES:

- Electrical conformity** IEC 335
- Protection degree** IP 65 EN 60529 (DIN 40050) with coil fitted by connector.

SPARE PARTS:

- 1. Coil:**
See coils list
- 2. Complete plunger:**
Code R450873
- 3. Complete armature tube:**
Code R450944/AL
- 4. Gasket O-Ring:**
Code R990002/S

KIT:

KT130AR30-A=2+3

DIMENSIONS:

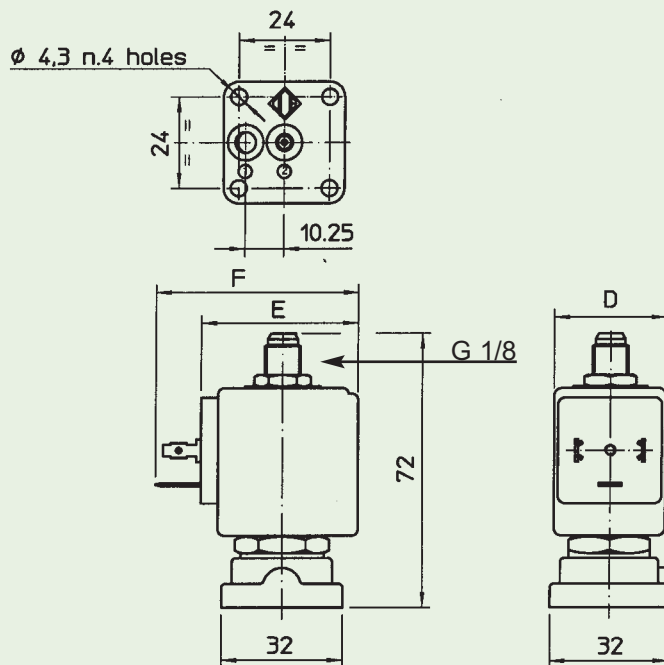

COIL	POWER ABSORPTION		TYPE	DIMENSIONS		
	Inrush VA ~	Hold VA ~		D mm	E mm	F mm
8 W	25	14,5	B	30	42	54
			S	32		